



AVENUES OF HONOUR IN THE LANDSCAPE - AUSTRALIA'S LIVING MEMORIALS

Diversity – conservation - renewal

Stuart Read, Australian Garden History Society

WW1: c60,000 died: 1 in 5 Australians & 18000 NZ

- huge impact, esp. on small communities
- all were volunteers: conscription debates

Australian soldiers at Vaire-sur-Somme, beside the (newly-taken) Somme River;

(Hyde Park ANZAC memorial hoarding)

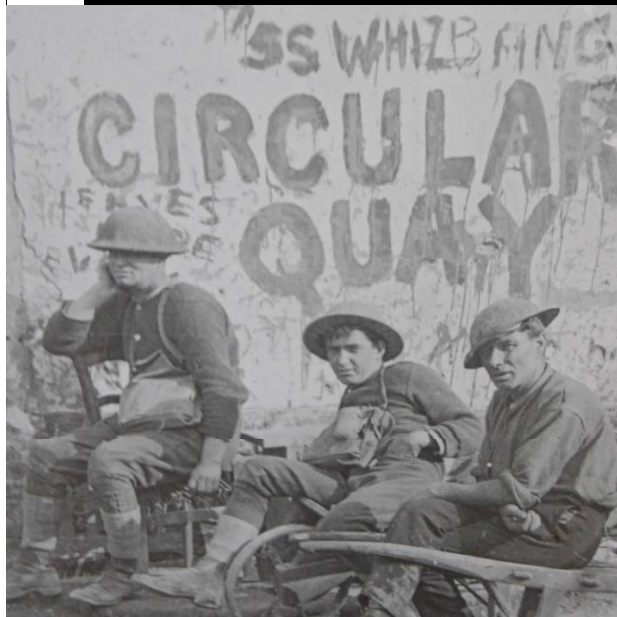
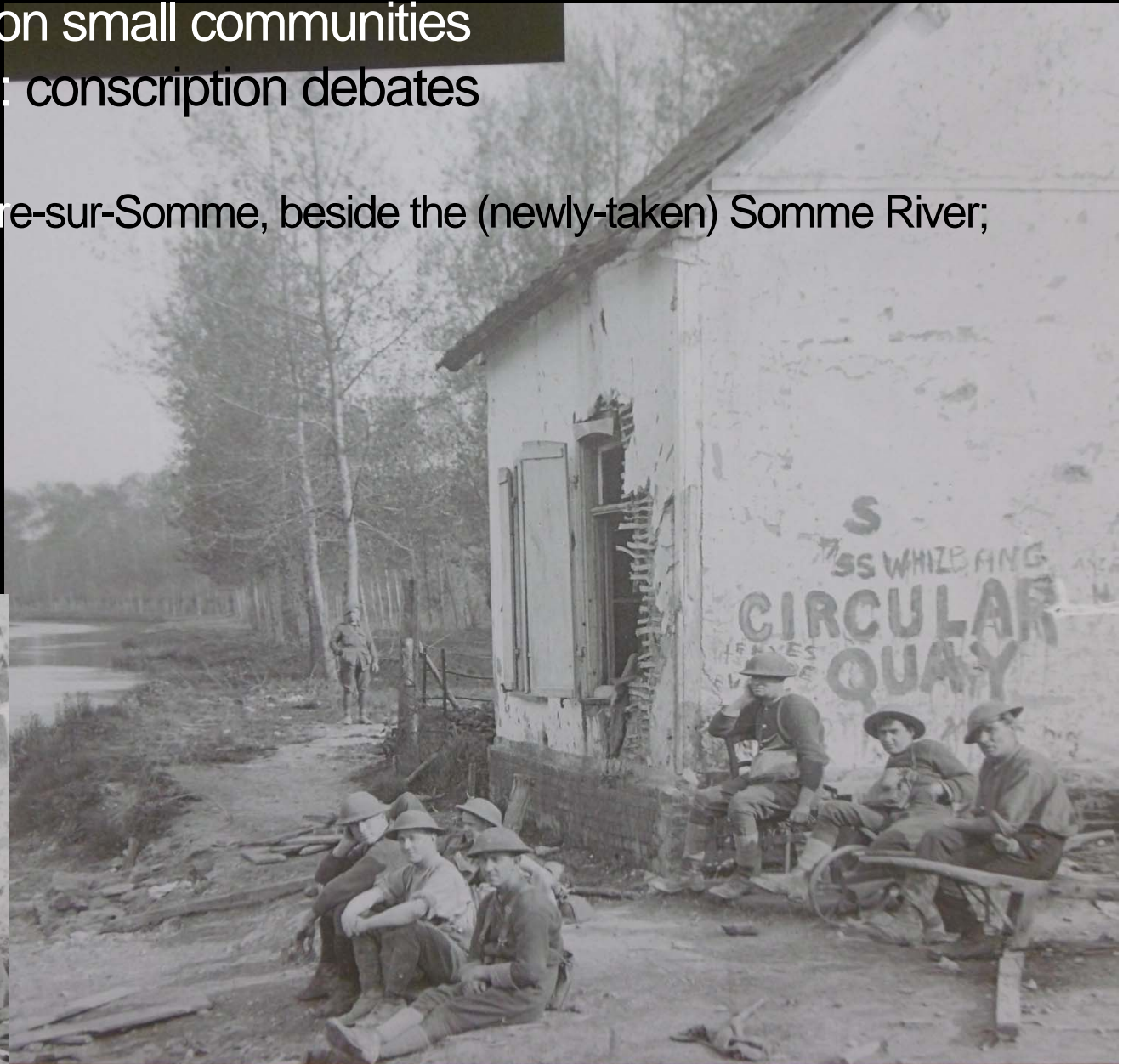

- 
- *the planting of trees bearing names of the war dead was being done in everyday landscapes of home towns, villages and cities of the dead. Since in many cases there was no body to bury, no gravestone to erect, planting of trees became an act of substitution, a tree for an actual grave (Mosse, 1990).*
 - *For many, the planting of a tree was both a private marking of a personal loss and public acknowledgement of the loss to the community as a whole; for some a cathartic act, for others the final loss of hope and acceptance of the death (Dargavel, 2000; Luckins, 2004).*

Woodend, Victoria (1918) (Sarah Wood)



AGHS approach differs from Treenet's:

- AGHS distinguishes by both era & types:
- Avenues of Honour = WW1
- Memorial Avenues = WW2
- Other war memorial ave's (Vietnam, Korea, Iraq, Afghanistan...)
- WW1, 2, later memorial groves / trees
- Notable avenues – not war memorial avenues
- Lone Pine trees & Gallipoli oaks, recalling high ANZAC losses at Gallipoli, Turkey

AGHS findings to date (more to check yet):

- 5 Boer War memorial avenues
- 383 Honour (WW1) Avenues
- 69 Memorial (WW2) Avenues
- 175 WW2 / later war avenues

Total war memorial avenues = 652, so far

+ 85 Lone Pines commemorating Anzac.

Notable upsurge in replanting, replaquing, new or replacement avenues for 2015 & 2018 Centenaries of Anzac & end-of-WW1.

Earliest WW1 avenues = 1915

South Australia & Victoria

- First Willunga, then Stirling, Mount Lofty, SA: 9/9/1915;
- Then c/o Victorian Education Dep't. , 16/6/1916
Arbor Day & ANZAC landing: Bendigo East, Vic. (removed 2016); Torquay, Grtr. Geelong and Eurack, Vic. both 23/6/16; Ceres, 30/6/16, Traralgon, Maldon & other Vic. towns
- Then Laurieton, NSW: 19/8/1916;
- Eumundi , Qld.; and in Hobart, Tas.: both 1917
- A.C.T. (Hall); & West'n. Aust.: King's Park: 1919



Laurieton, NSW (19/8/1916): oldest in NSW
mixed species: camphors, Araucarias; 2 streets in a 'X'



Laurieton.

Showing trees planted in memory
of our Soldier Boys

NSW: planted for all volunteers: by some, pre-leaving



Cudgewa, Upper Murray R., Vic. (3/8/1917)

a strong element in a grand rural landscape



Cudgewa, Vic. (3/8/1917): oaks (*Quercus castaneifolia*, *Q. palustris*) & elms (*U. x hollandica*, *U. procera*), planted by school children

Beeac, Victoria (two in town: 7/1917 and 1945): both of elms (Treenet)



AVENUE OF HONOUR
To commemorate the fallen
World War I
Planted July 1917

Victor Harbor, South Aust.: 4/1917, 1918

Norfolk Island pines (Expedia; State Library of SA B 73333 / 14
(Charles Hoffmann, c1930 – NB: donation box for the gardens)



Queen's Domain, Hobart: 1890s King's Avenue

(beautification).NB: Soldiers' Walk to the lower right (1917, 3/8/1918, 15/2/1919, 1925) 536 Atlas & Himalayan cedars (*Cedrus atlantica* & *deodara*)



Hobart Soldiers' Walk: 1917-19 and 1999 replanted cedars and cypresses (Gwenda Sheridan)



W. Tamworth, NSW:

8/1918, New England Highway & Gipps Street, six blocks, mixed species planted by Mayor and the soldiers' mothers. West Tamworth Girls' Club - Women War Workers' Association (Chris Betteridge)



Ballarat : 4/6/1917 (500 trees/ first 500 enlisted – 1919 & Arch (1920). Was 3801 trees over 22km of road – 3332 survive: varied (23) species (of elms, poplars, oaks. The Lucas Girls planted many (1997 Mark McWha Management Plan)



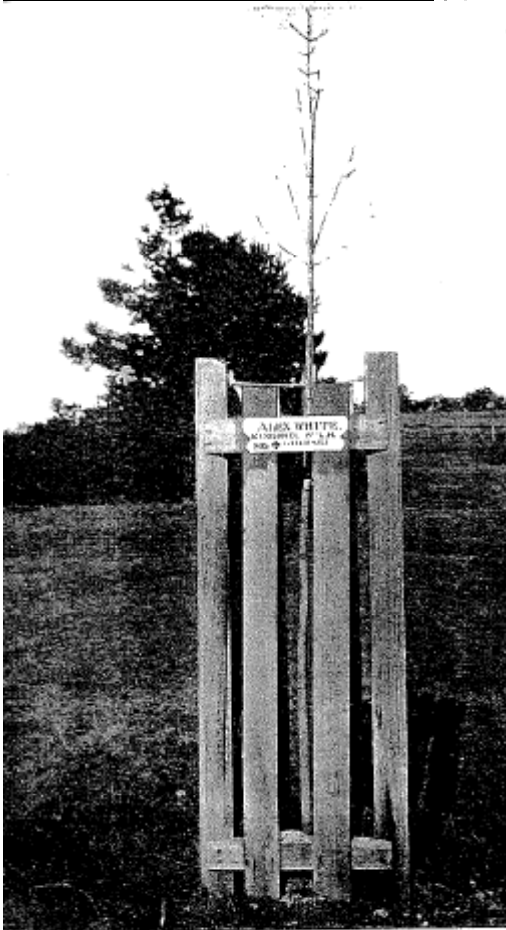
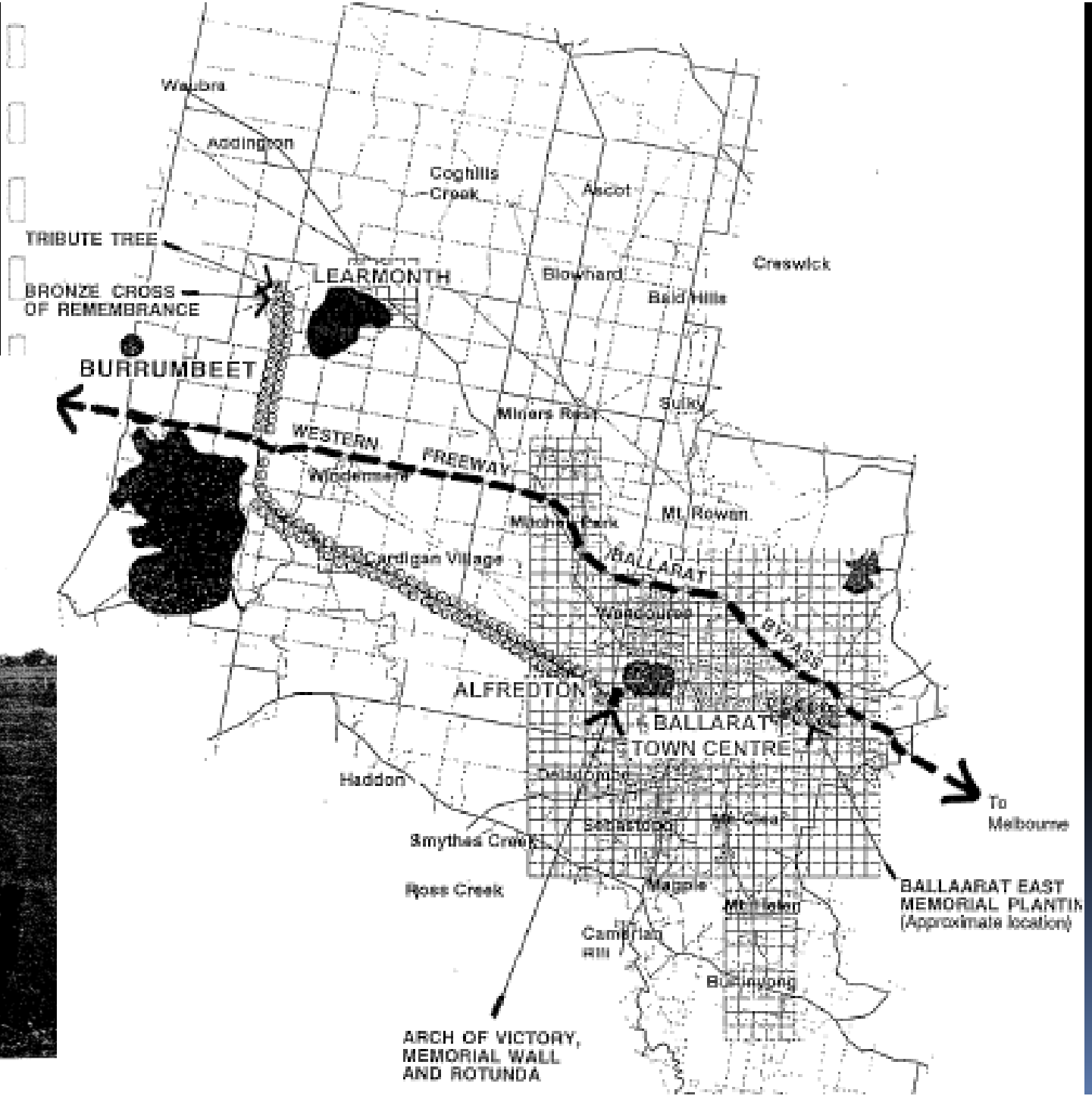
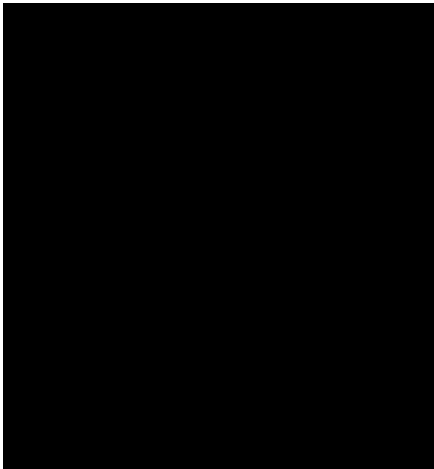

INDIVIDUAL TREE.

9 AVENUE TREE PLANTING LIST



LIST SHOWING THE VARIETY OF
TREES IN THE AVENUE,
AND THE ORDER IN WHICH THEY ARE PLANTED.

	Nos.	
380 Elms (3 varieties)	1 to 380	
80 American Ash	381 to 460	
45 English Ash	461 to 505	
50 Mountain Ash	506 to 605	
150 North American Maple	606 to 755	
50 Scarlet Oak	756 to 805	
50 Norway Maple	806 to 855	
20 Broadleaf Maple	856 to 875	
20 English Maple	876 to 895	
30 Alder Trees	896 to 925	
75 Mountain Ash	926 to 1000	
50 Lime Trees	1001 to 1050	
100 Elms (2 varieties)	1051 to 1150	
50 Ontario Poplars	1151 to 1200	
50 Silver Birch	1201 to 1353	
50 North American Maple	1354 to 1404	
16 Deciduous Cypress	1405 to 1421	
30 Oaks (Sailors)	1422 to 1452	





TO THE MEMORY OF
PTE. C. F. ABRAHAM
49TH. BATTALION A.I.F.
DIED OF WOUNDS IN FRANCE
OCTOBER 20TH. 1918.

Eumundi, *Clem Park*, Queensland
(1917+) Hill's fig, *Ficus microcarpa*
ssp. hillii (Treenet)



Corryong, NE Victoria: (1918) Himalayan & Atlas cedars (*Cedrus deodara*) & pin oaks (*Quercus palustris*) (Treenet)



Woodend, Victoria (14/9/1918) English & Algerian oaks
(*Quercus robur*, *Q. canariensis*), 2.4km long (Treenet)

Drummond, C. Victoria, 16/9/1918 – originally mahogany gums – failed and replaced with Scottish elms (*Ulmus glabra*) (Treenet)



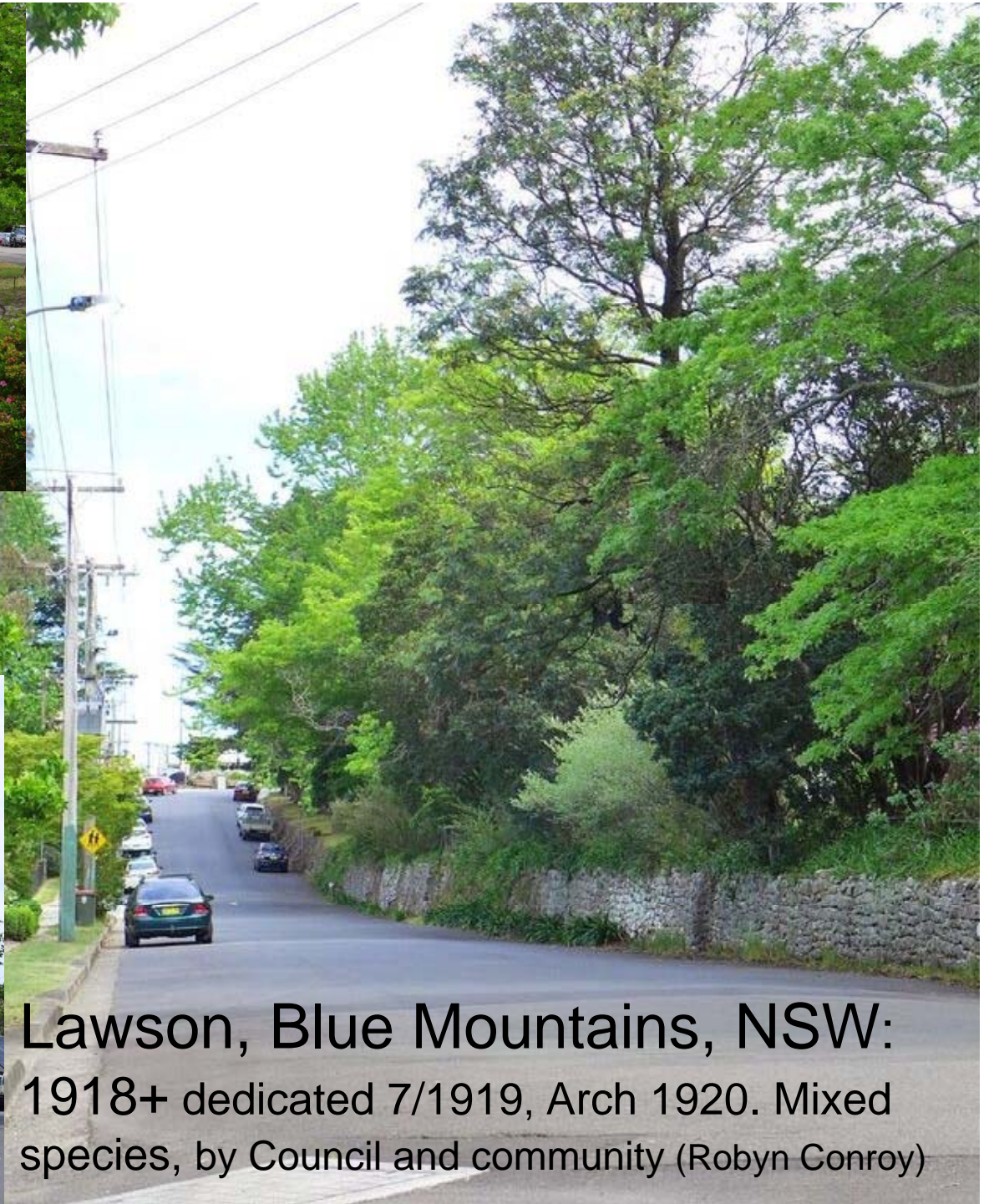

Lawson, Blue Mountains, NSW:
1918+ dedicated 7/1919, Arch 1920. Mixed
species, by Council and community (Robyn Conroy)

Moyston, W. Victoria, 2/8/1919, Monterey pines
(*Pinus radiata*)(Chris Betteridge)





Lovekin Drive, King's Park, Perth (ded.3/8/1919)
> 800 trees. Originally oaks, planes, Replanted 1945 with bangalays (*Eucalyptus botryoides*) (1917)



Barellan, nr. Griffith, NSW (1920)
Peruvian pepper (*Schinus molle*) (Treenet)

PEPPER TREES
IN YAPUNYAH STREET
The Pepper Trees were planted
on 27th August, 1920
in memory of the Fallen of the District,
in World War I, by their relatives.



Roma, Queensland, 1918-20,
bottle trees (*Brachychiton rupestris*)
(Treenet)

Wangaratta, Docker's Plains, Vic.:1921, sugar gums (*Eucalyptus cladocalyx*) by school children (Chris Betteridge)



Gostwyck, Uralla, NSW (c.1921): Y- triple avenue of European elms, planted for Major. Clive Collingwood Dangar MC, 1882-1918, d. Palestine of bomb-wounds

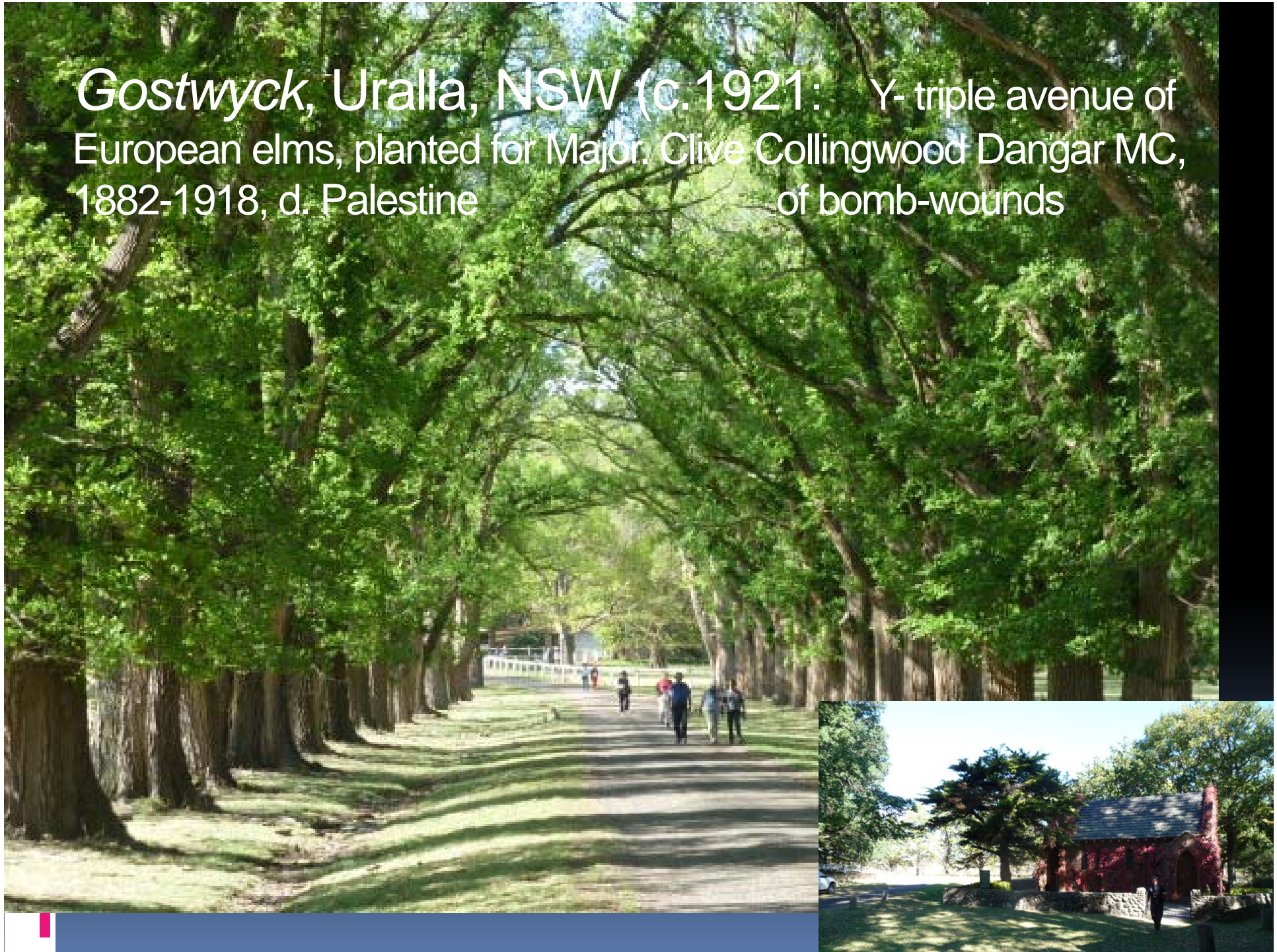

Anzac Memorial Grove, Mango Hill, Petrie-Redcliff, Qld. (1925-6), *Mangifera indica* 3 rows, originally 1760 trees, over 18km (John Taylor)



Canary Island date palms (*Phoenix canariensis*)

symbolic: e.g. L: Albury (1945+); R: Burwood, NSW (1923)

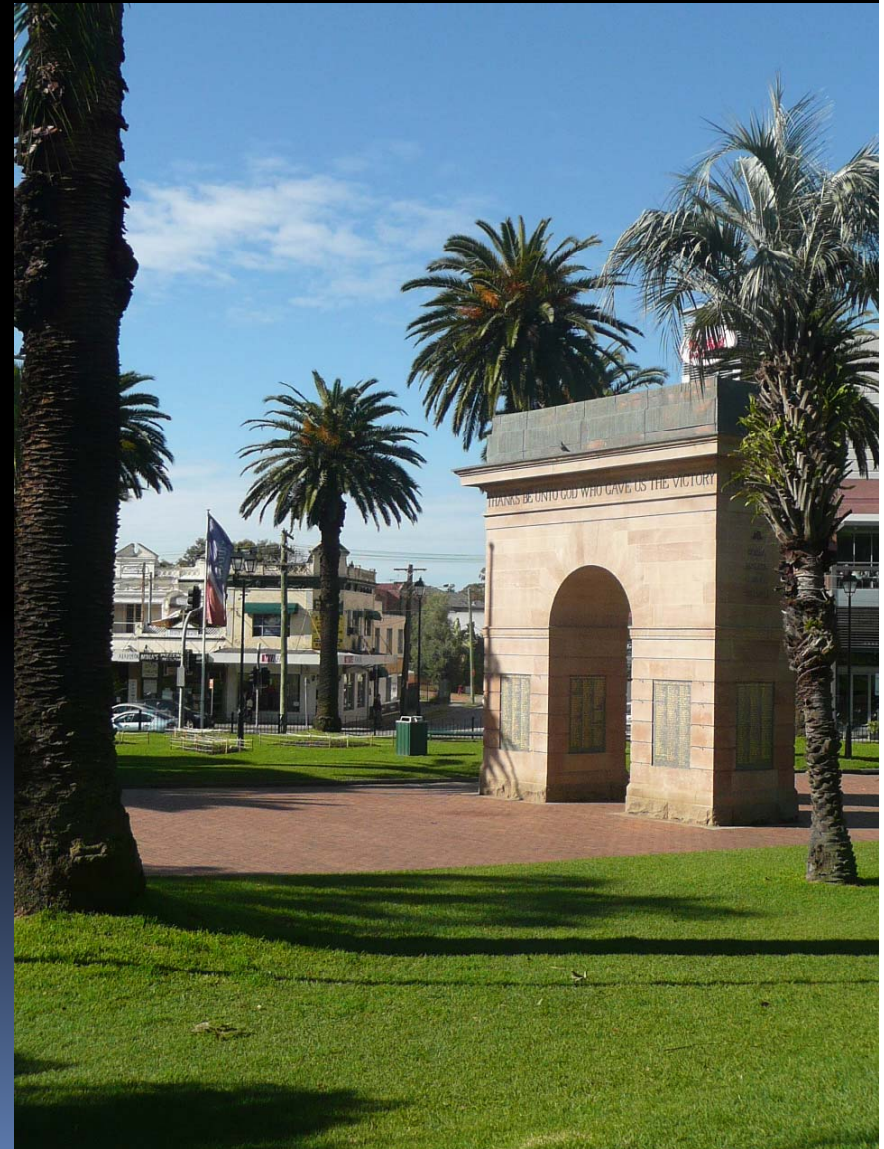
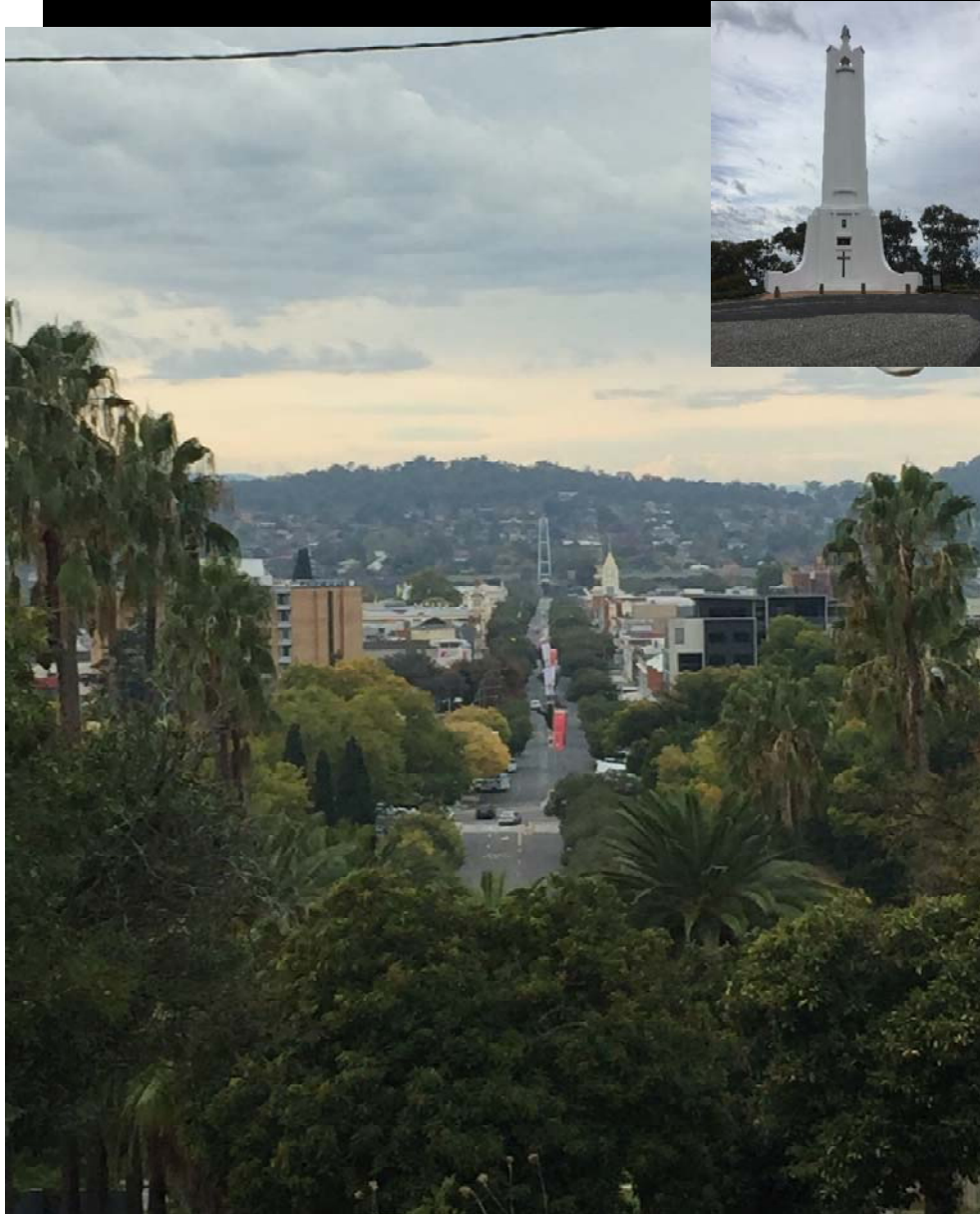

Shrine of Remembrance, Melbourne (1933)

Flanking Bhutan cypress (*Cupressus torulosa*) avenue is notable,
if not a war memorial avenue (John Gollings photo)

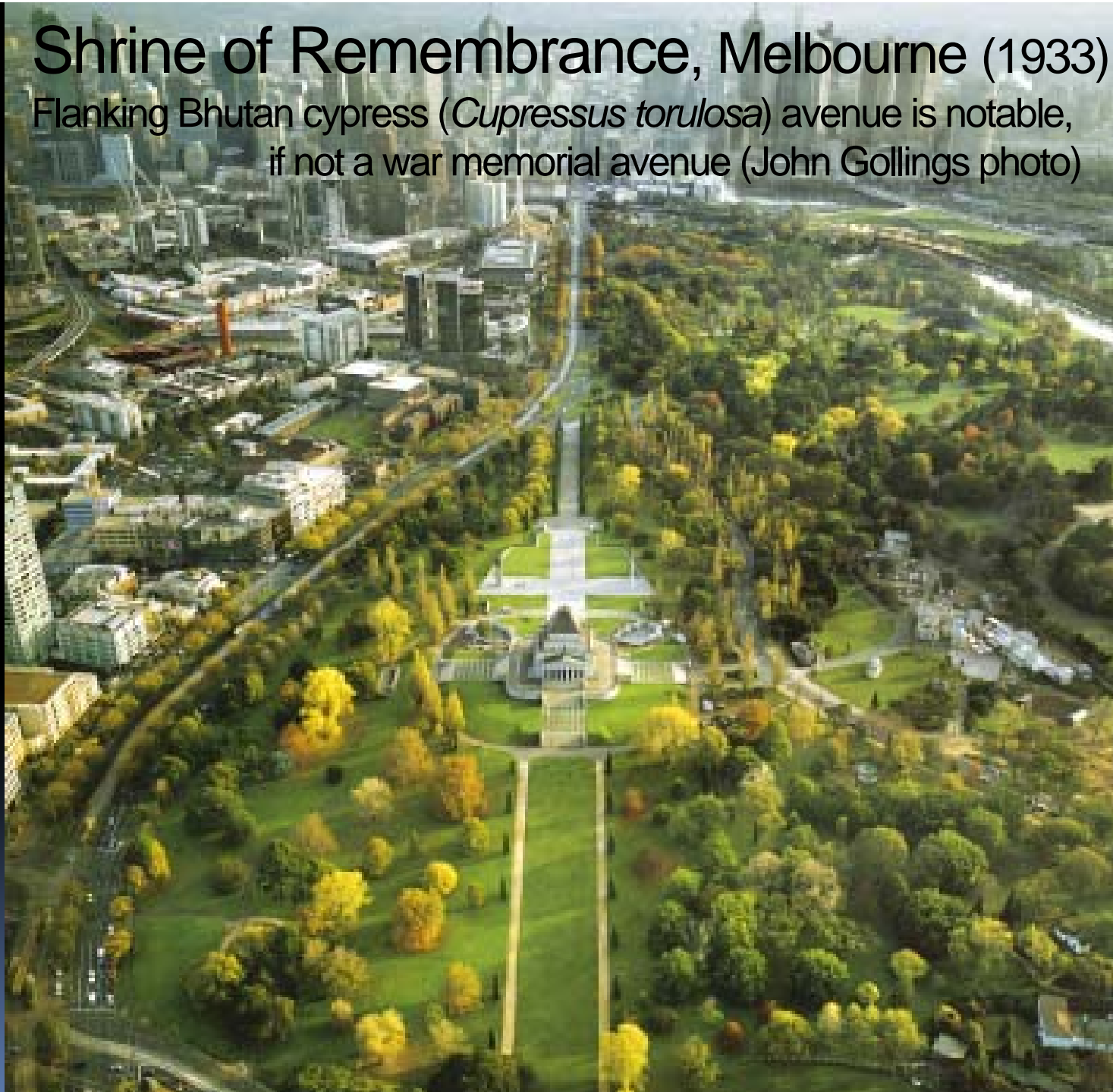

ANZAC Memorial, *Hyde Park*, Sydney

(14/10/1935: fastigiata white poplars: removed & replaced in 2017 w/ fastigiata tulip trees (*Liriodendron tulipifera*)

(2015 AGHS visit photo)



100
YEARS OF
ANZAC
THE SPIRIT LIVES
2014 - 2018

Fraser Avenue,
King's Park, Perth

Lemon-scented gums
(*Corymbia citriodora*)

1938, not originally an
honour avenue

1966 dedicated as an
honour avenue



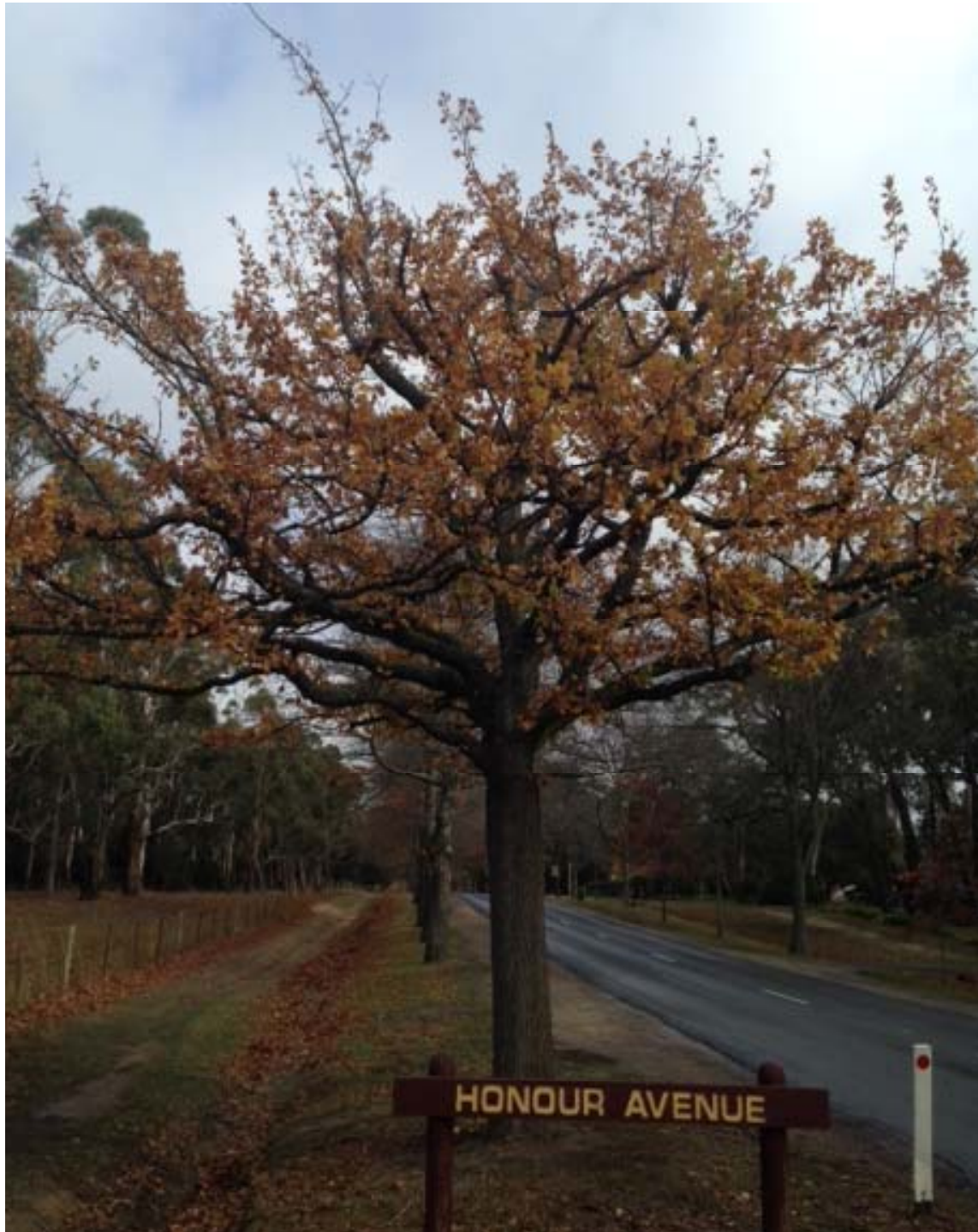

Issues: termites & bush or grass fires:

Mount Macedon, Vic.:
1918 original - pin oaks (*Quercus palustris*). 2 Algerian oaks (*Q.canariensis*) added later.

1926 some replaced due to termites.

1983 Ash Wednesday bush fire killed some: replaced.

Dedicated to WW1 & WW2

Issues: Need for regular pruning to maintain canopy integrity of brittle species (Mortlake, Vic.: Monterey cypress (Aust. ICOMOS))



Pruning / Sculpture and
better signage
Lakes Entrance Vic., (1924)
(Treenet)

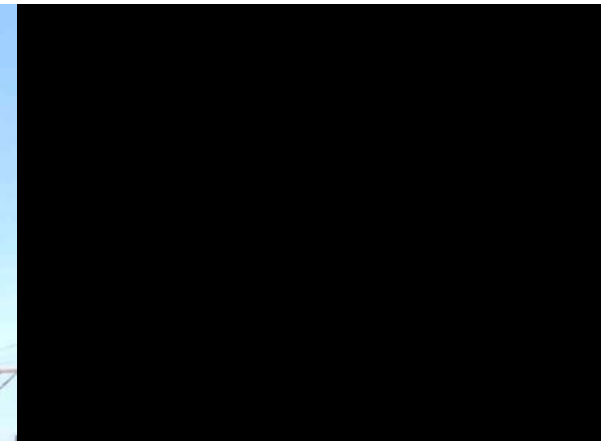

Dartmoor, Vic.:
1918 (Treenet)

Need for ongoing management: monitoring, pruning, irrigation, replacing trees, plaques, interpretation, fencing, overhead wires – pruning (Ballarat AOH CMP)

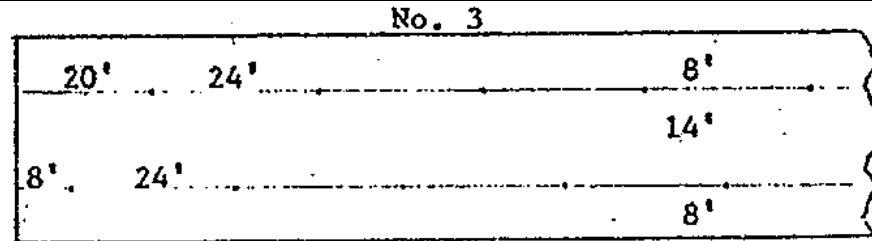

- 41 No. *Euc. rubida*
(Candlebark)
- 42 No. *Euc. sideroxylon*
(Red Ironbark)

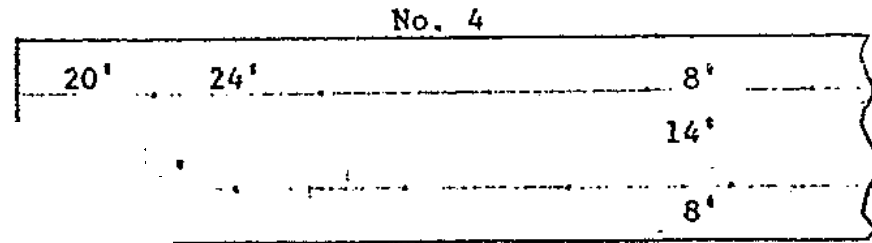

- 41 No. *Melaleuca styphelioides*
(Prickly-leaf Paperbark)
- 42 No. *Melaleuca linariifolia*
(Flaxleaf Paperbark)

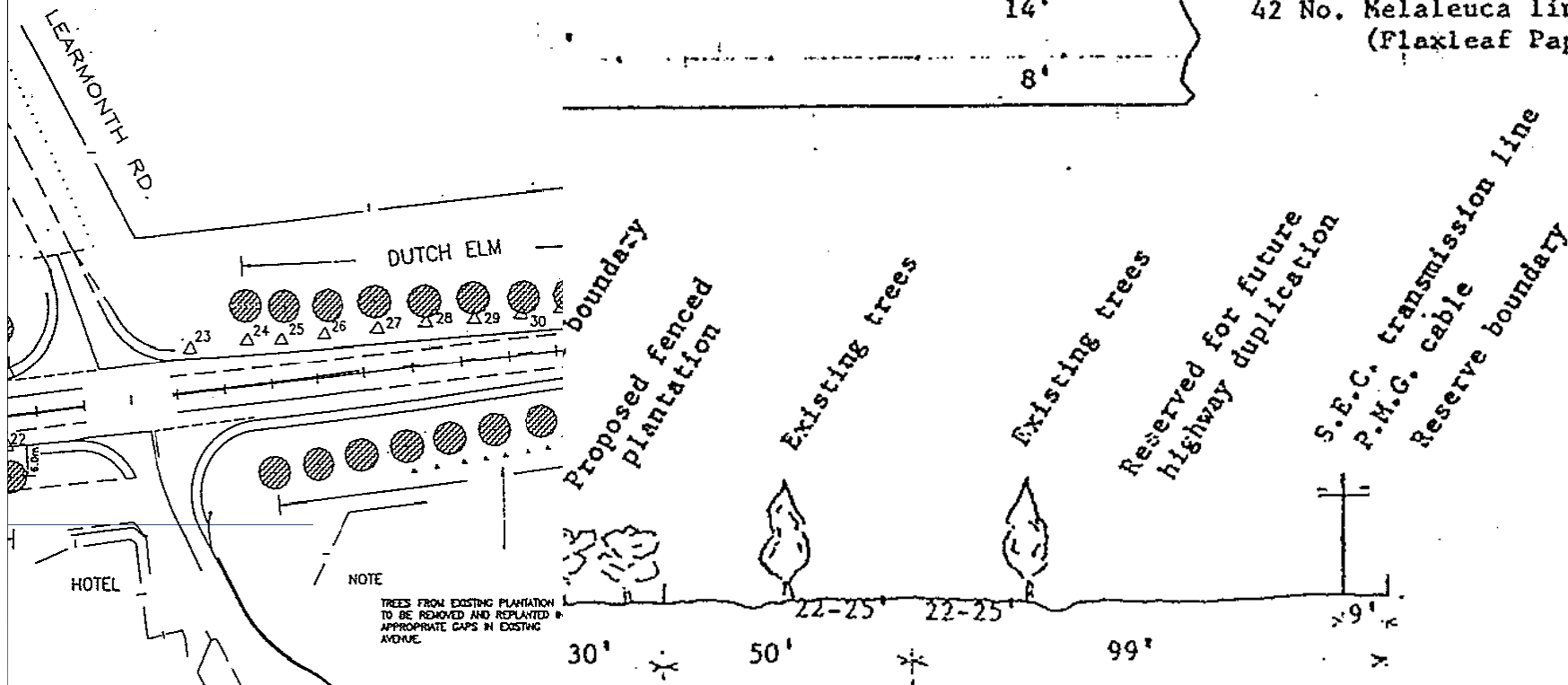

A.2.1 Plan A & Section AA Northern Approach (Northern section)

TYPICAL CROSS SECTION AA

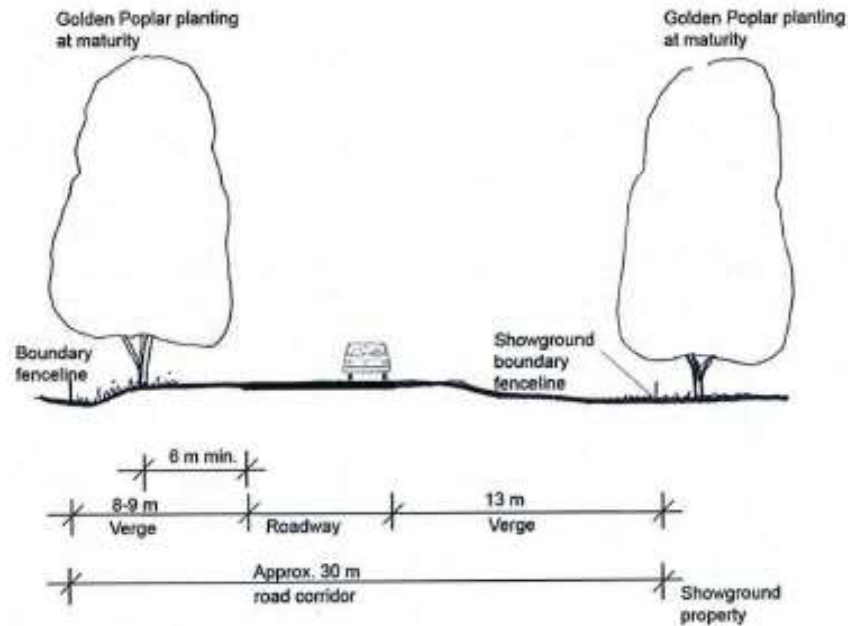

TYPICAL PLAN A

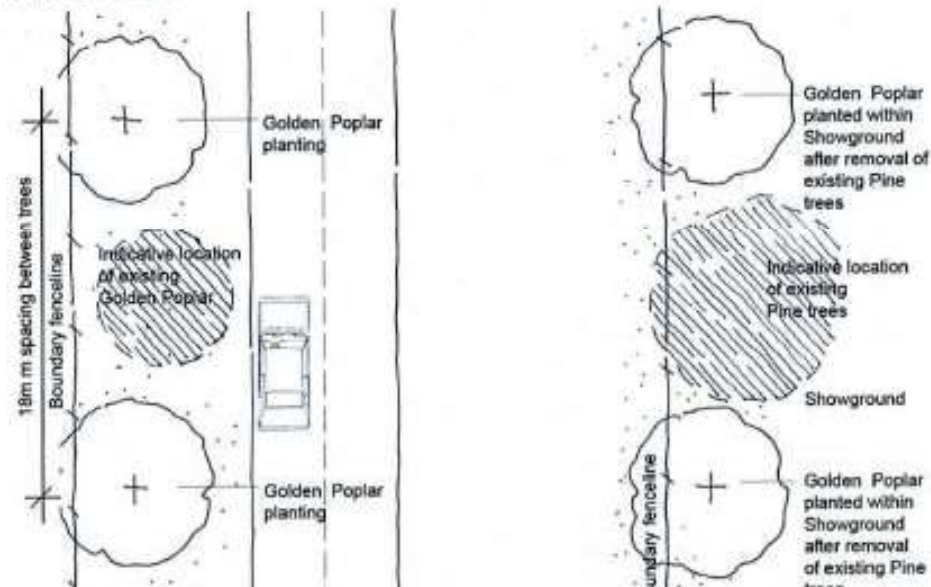

○ Realign new plantings at wider, safer distances from road

○ Plant inside / outside rd. corridor

= Replanting era: non-war memorial avenue of oaks, Park Drive, *Parramatta Park*, NSW





Mickleham, Vic. (c1918 original river red & sugar gums, removed). 2002 replanted 61 r. r. gums: children, veterans...



Pushback for Woolpack members with Glenda Jones presenting the 3300 signature petition to Member for Western Victoria, Simon Ramsay MP. Photo Eleisha Dennis

Petition starts journey

By Kate Taylor

A 3300 - signature petition calling for the re-instatement of extending Woolpack Road as an option to solve Bacchus Marsh's

President of the Group, Malcolm Trask explained the path the petition will now travel.

"What will happen is that Simon Ramsay is an MLC (Member of the Legislative

Liberal Member for South Barwon Andrew Katos.

"He'll be doing that on behalf of us, because Simon is our local Liberal member, we wanted him because the Liberals are in

Issues: Road-widening and upgrades

Need for lobbying

Bacchus Marsh, Vic. v Roads Dept.

1300-strong petition pushes for another option for local roads

(and won, for now)

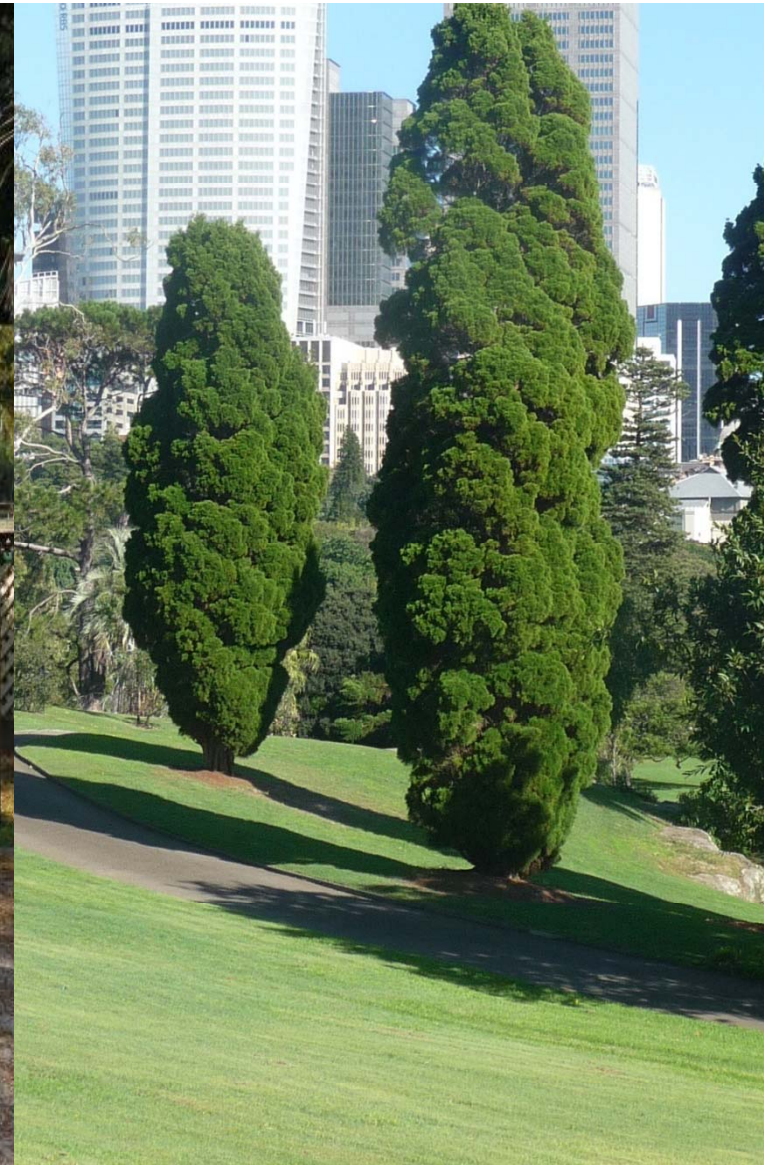

Conflict: camper van and tent spots v 8/1918 coastal cypress pines (c.150, in a grid) (*Callitris columellaris*)
Brunswick Heads Terrace Reserve Holiday Park (L photos by others)

It would seem some care (Anzac Ave., Sydney)



c/o *The Wentworth Courier*

Social value: local community... people power

Waiting lists are spilling out into the street from a busy every private school in the Eastern Suburbs — Patrick McCann

Ankle-biters plan to bring the council to its knees

Rob Bates

WAVERLEY Council felt the full force of the Young Turks at Wee Care Kindergarten, Bondi Junction, yesterday, when 30 tiny-bits activists handed mayor Sally Betts a petition with 41 signatures opposing the planned removal of trees in Waverley Park.

The council had planned to chop down the trees to make way for the new Waverley Pavilion, but Wee Care's owner, Ruth Weinstein, said the children were opposed to this decision.

"We've been talking about conservation and the environment, so we told the children that this might happen and they were really upset," Ms Weinstein said. "I think it was an important lesson for the children that they have a voice and that part of their social responsibility is to talk about things that upset them and make people aware."

The petition will be tabled at the next council meeting.



Frederique Simms from Wee Care Kindergarten hands the children's petition to Waverley mayor Sally Betts.

Photo: ALAN F

Ballarat avenue section replanting (Chris Betteridge)





**The Ballarat Avenue of Honour
was officially re-connected
on 12th April 2015**

**by Senator the Hon. Michael Ronaldson
Minister for Veterans Affairs
Minister Assisting the Prime Minister
for the Centenary of ANZAC
Special Minister of State
and Hon Luke Donnellan MP
Minister for Roads and Road Safety**

Lists of Avenues of Honour; Memorial
Avenues; Lone Pines etc are at:

www.gardenhistorysociety.org.au
& www.treenet.net.au

(photos: Treenet)



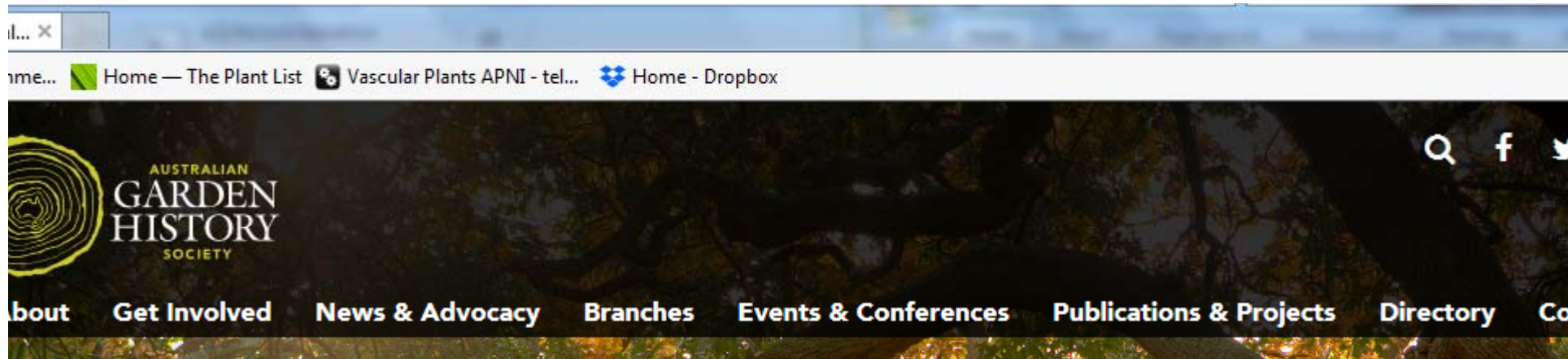

UPDATED! Call For Proposals National 'Landscapes At Risk: Watch & Action' List

Posted on July 9, 2017 in [Advocacy](#), [News](#), [Reports](#)

'Landscapes At Risk: Watch & Action' List

At National Management Committee meeting in June 2015 it was decided to prepare a list of 'Landscapes at Risk', as part of our mission to promote awareness and conservation of significant gardens and cultural landscapes through engagement, research, advocacy and activities should be developed. This has lead to the development of a 'Watch & Action' list.



Positive actions:

State Government:

Victoria is doing a 2018-2020 survey of avenues, condition assessments, nominations to state heritage register. Run via Dept. of Premier & Cabinet and by Heritage Victoria.

Community Groups:

National Trust of Australia (Victoria) is nominating all Victorian avenues (WW1, WW2, etc) to its Significant Tree Register (non-statutory protection, but useful community information device).

Tasmania: FOSMA (Friends of Soldiers' Memorial Avenues) have done an online self-help guide for communities:

2006, *The Avenues Kit: a complete guide to restoring Memorial Avenues of Honour in your community*

Calder-Woodburn Highway, Victoria – double avenue rows (Sarah Wood)



With special thanks to:

- **Glenn Williams**, Treenet (TREENET photographs)
- **Sarah Wood**, Australian Garden History Society (Woodend, Calder photographs)
- **Robyn Conroy**, town planner (Lawson AOH photographs)

- Australian Garden History Society **national management committee**

- **Cockerell, Sarah**, 2004, *TREENET Avenues of Honour Survey*, in TREENET, Proceedings of 5th Street Tree Symposium, 2-3/9/2004, University of Adelaide

- **Dargavel, John**, 2000, 'More to Grief than Granite: Arboreal remembrance in Australia', in *Journal of Australian Studies*, 64, 187-195

- **Luckins, T.**, 2004, *The Gates of memory. Australian people's experiences and memories of loss and the Great War*, Curtin University Books: Freemantle

- **Mosse, G.**, 1990, *Fallen Soldiers: Reshaping the Memory of the World Wars*, Oxford University Press: New York



E: stuart.read@environment.nsw.gov.au

Stuart writes for: www.gardendrum.com

www.gardenhistorysociety.org.au

Daylesford, Vic. (8/1918)